

6.3.2 DISCOVERY SQUARE

6.3.2.1 DISCOVERY SQUARE PRINCIPLES

The Institutes: Technology and Science in the City fostering Private Development

Discovery Square is the focal point for the expansion of the “Science and Technology Institutes” of Mayo Clinic and an ideal location to expand private research, technology and related business in the downtown area. Located steps away from the Gonda Building and the Mayo Medical School, Discovery Square is positioned to take advantage of these proximities that are essential for the continued growth of the research and bio-medical and bio-technology community. The buildings are designed with the idea of establishing a more robust Rochester skyline. The science buildings are grouped around a beautiful and lively urban square that appeals to the widest constituencies of city dwellers. The Square provides interconnected indoor and outdoor meeting places that function as centralized gathering spots for visitors, scientists, researchers and the medical community to co-mingle and collaborate. (Figure 6.3-13) The Square is designed to be playful and artful, similar to the Google Commons in order to, quite simply, attract the best and the brightest, the most creative minds in the world.



The Square is an environment designed to attract the best and brightest of the next generation

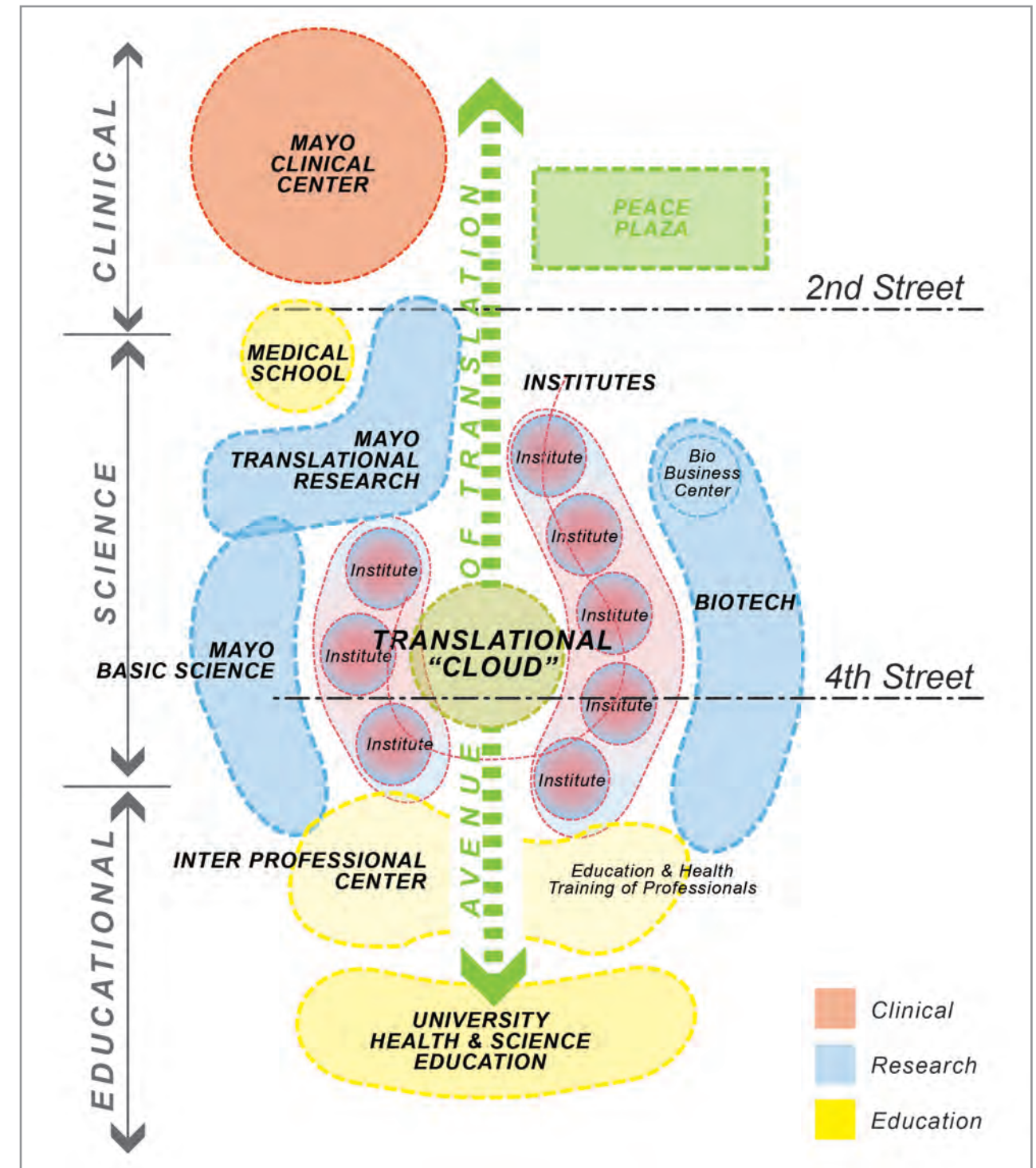

FIGURE 6.3-13 - Discovery Square Organizational Diagram

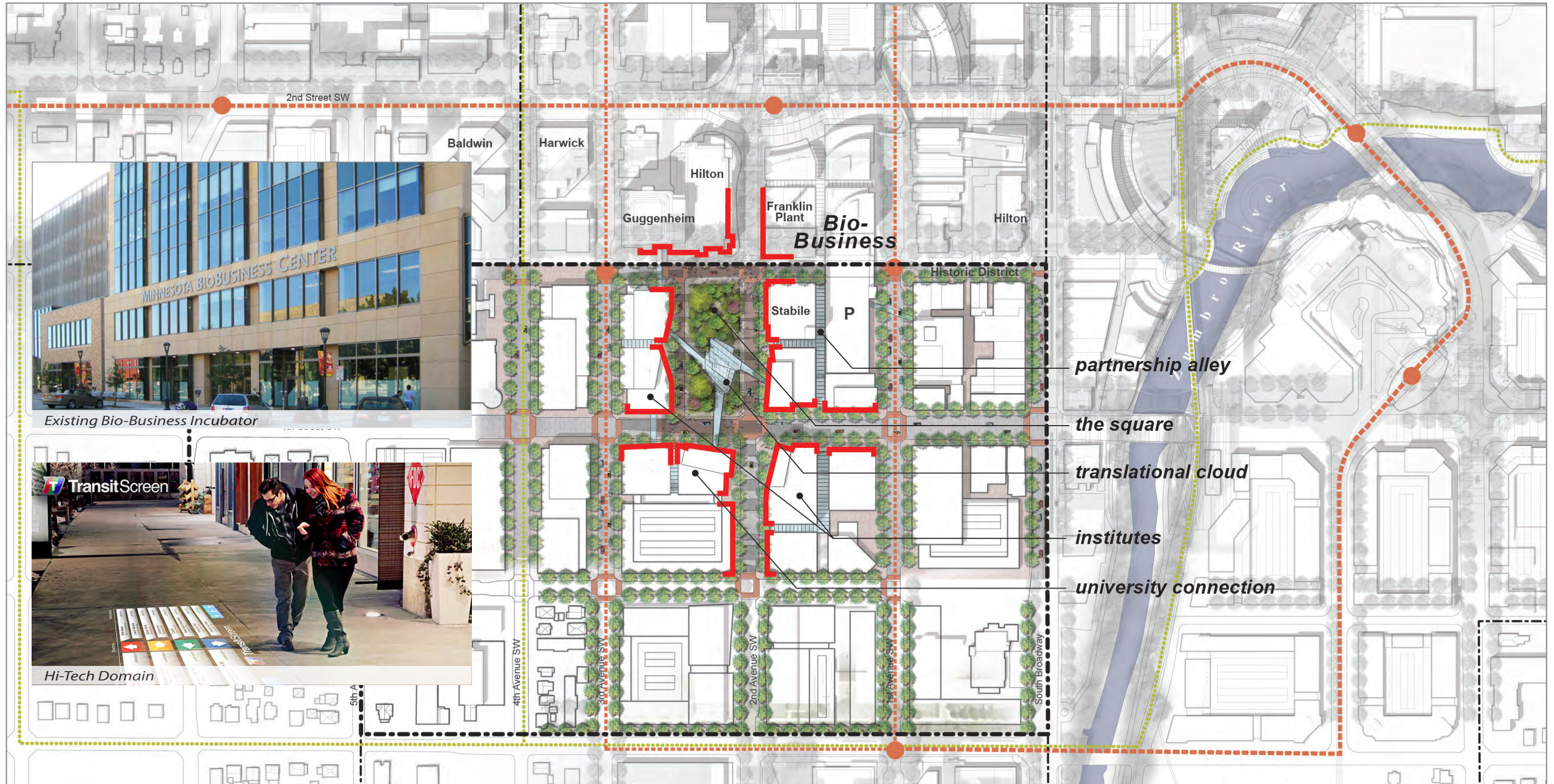

FIGURE 6.3-14 - Discovery Square Illustrative Plan

6.3.2.2 DISCOVERY SQUARE KEY PLACES

- **Hi-tech Domain** – State-of-the-art technology would be embedded into and around the buildings and public spaces of Discovery Square allowing workers, visitors, and patients to receive information in real time
- **Institutes** – A series of flexible and interdisciplinary lab lofts that provide state-of-the-art facilities in an open, connected, and collaborative vertical campus
- **Partnership Alley** – Building off the alleyway system, a network of inter-connecting passageways for an integration of buildings and communities
- **The Square** – A Wi-Fi connected urban park suited to the 22nd-century, providing a unique setting for the best and the brightest to engage in creative interactions within a beautiful urban public square (Figure 6.3-15)
- **Translational Cloud** – A glowing glass pavilion hovering in the air above The Square connecting all of the buildings serving as a meeting place for conferences and events (Figure 6.3-16)
- **University Connection** – Programmed spaces and a campus linkage system that strengthen the relationship between Mayo Clinic, Mayo Medical School, the University of Rochester and other institutional partners
- **Windows on the Institutes** – Contemporary open storefronts and bay windows that overlook The Square, inviting the outside world inside for a glimpse of the life and creative activity going on inside



FIGURE 6.3-15 - The Square

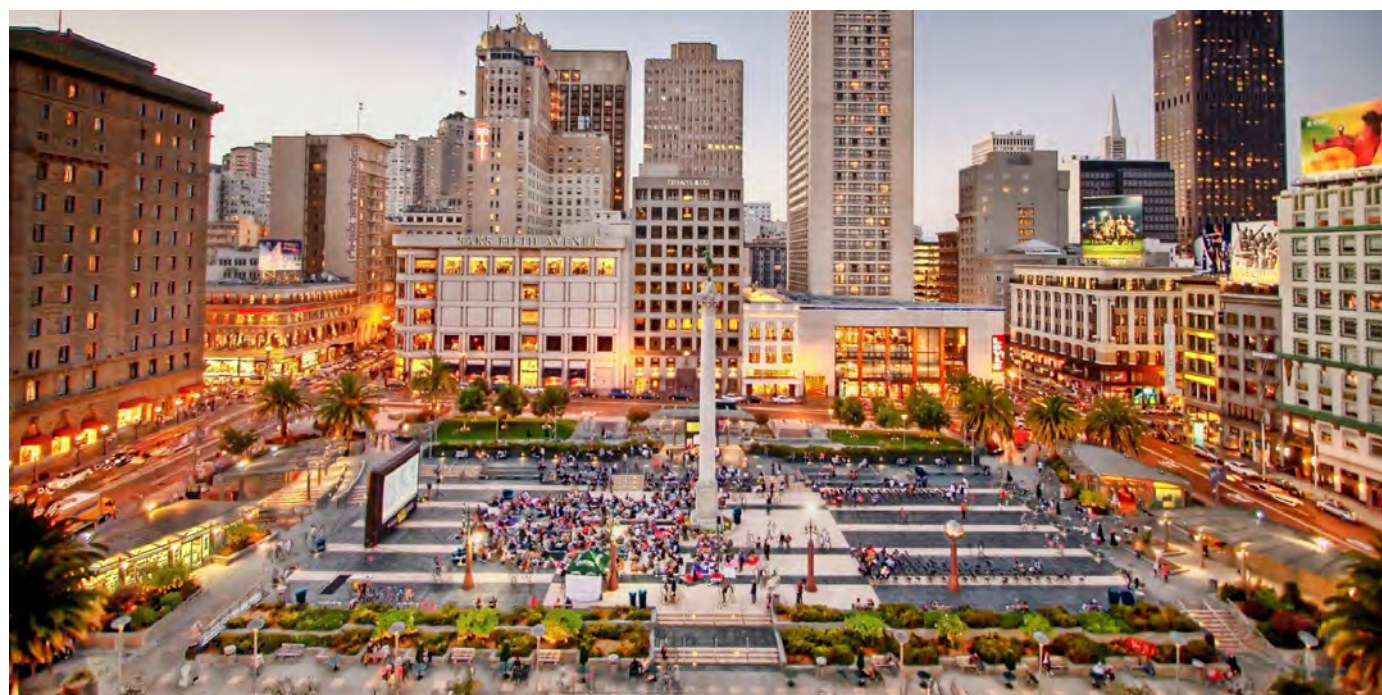

Central space for development - Union Square, San Francisco



FIGURE 6.3-16 - Translational Cloud

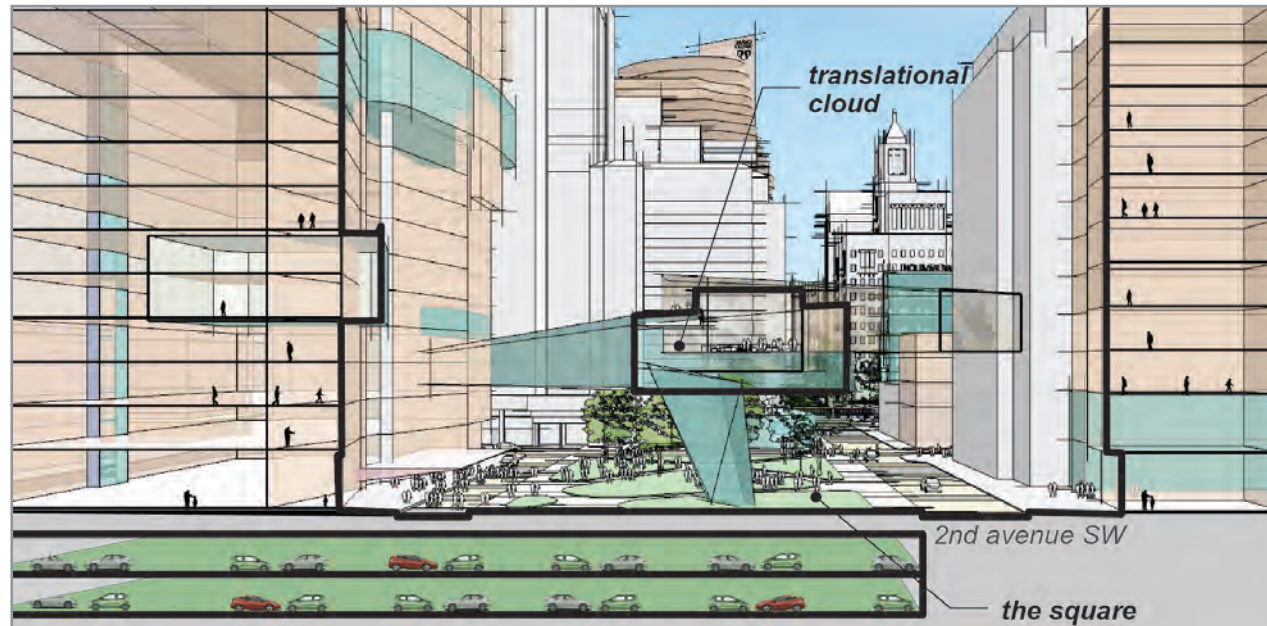

FIGURE 6.3-17 - Discovery Square Section

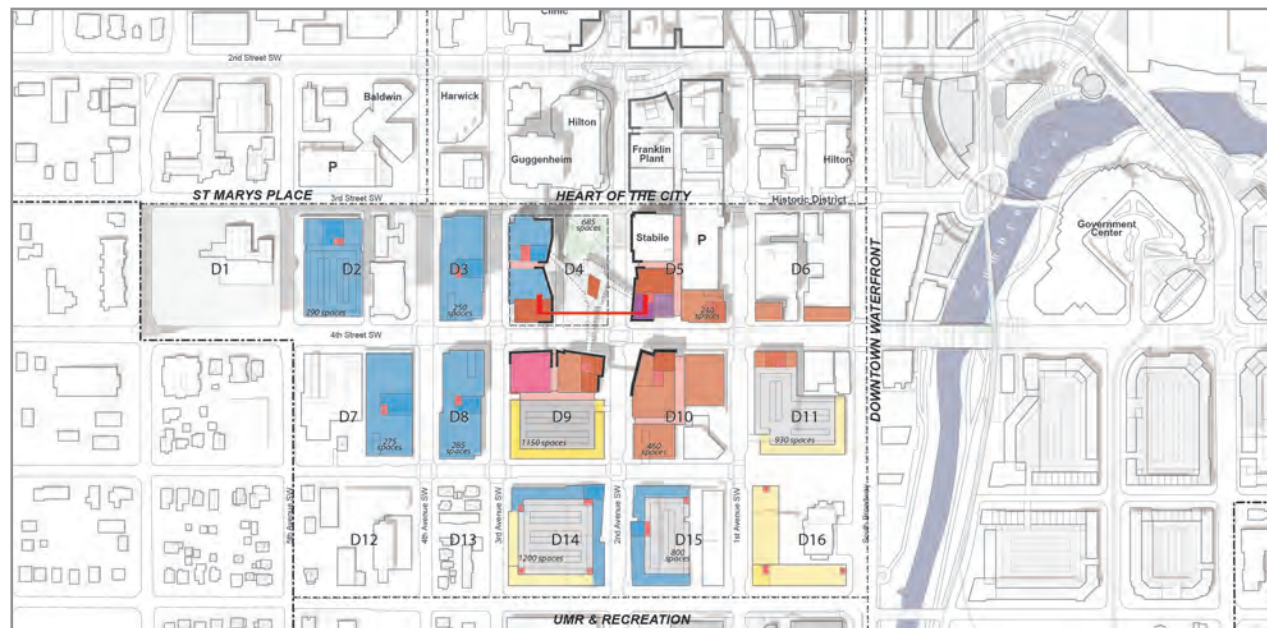

FIGURE 6.3-18 - Discovery Square Ground Level Plan

6.3.2.3 DISCOVERY SQUARE PROGRAM

Figure 6.3-19 provides the development program for Discovery Square based on the market analysis. For more details regarding building height, scale and density within Discovery Square, refer to Appendix 5, Design Guidelines.

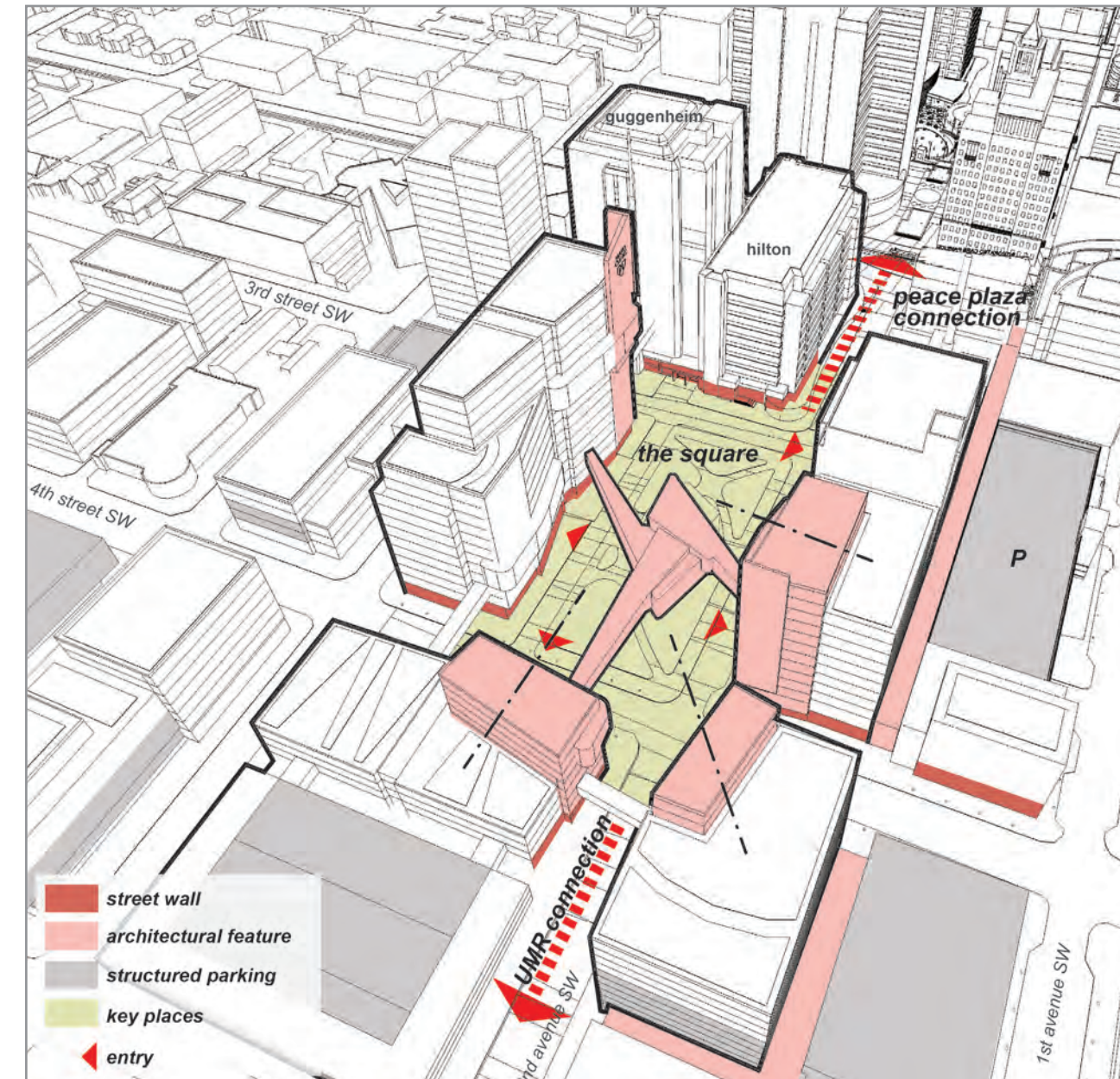

FIGURE 6.3-19 - Discovery Square Massing

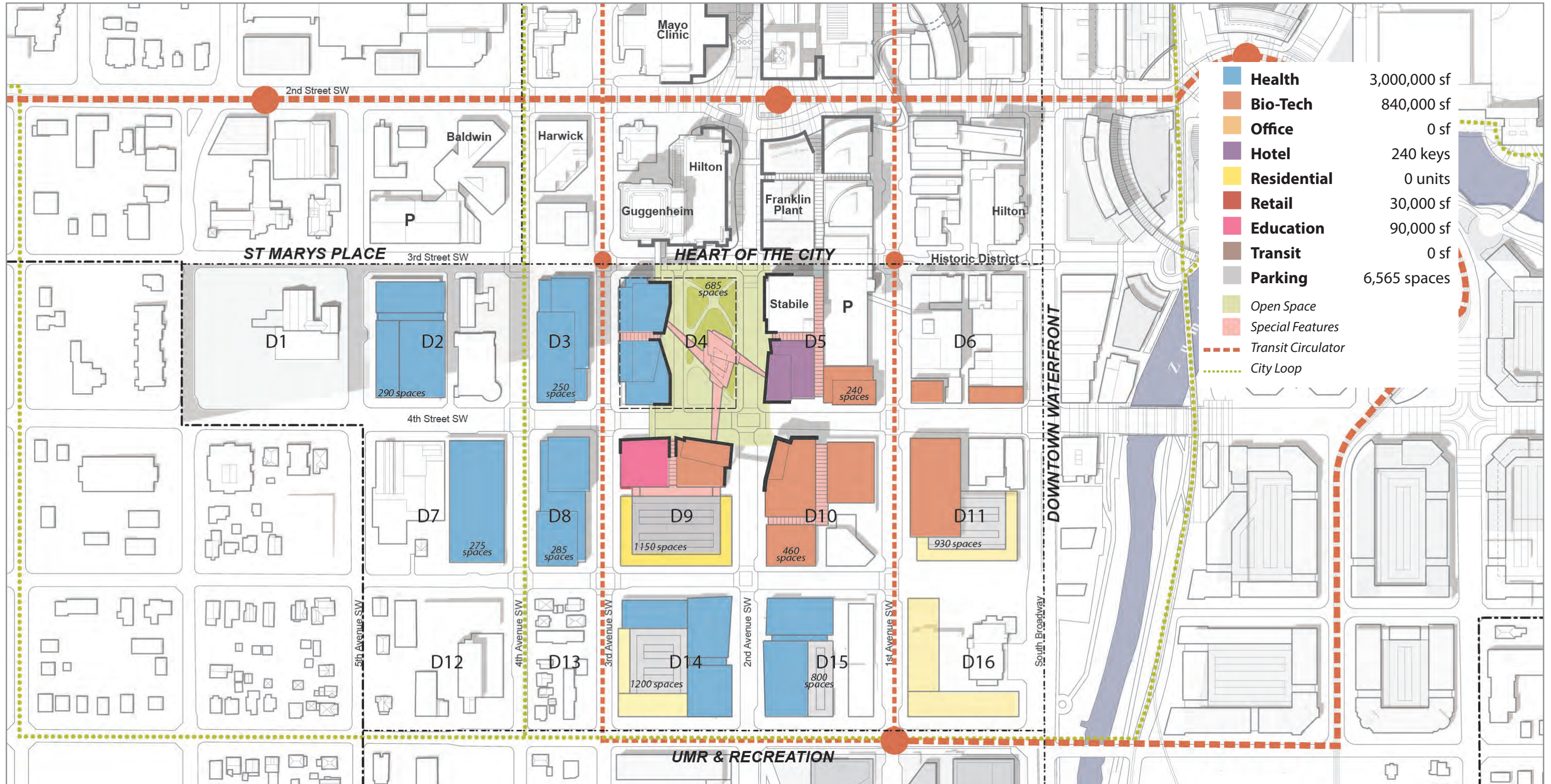

FIGURE 6.3-20 - Discovery Square Program Plan



FIGURE 6.3-21 - Discovery Square Aerial